

VHLife 氫自在

600cc 2-in-1 H₂ Generator Operating Manual

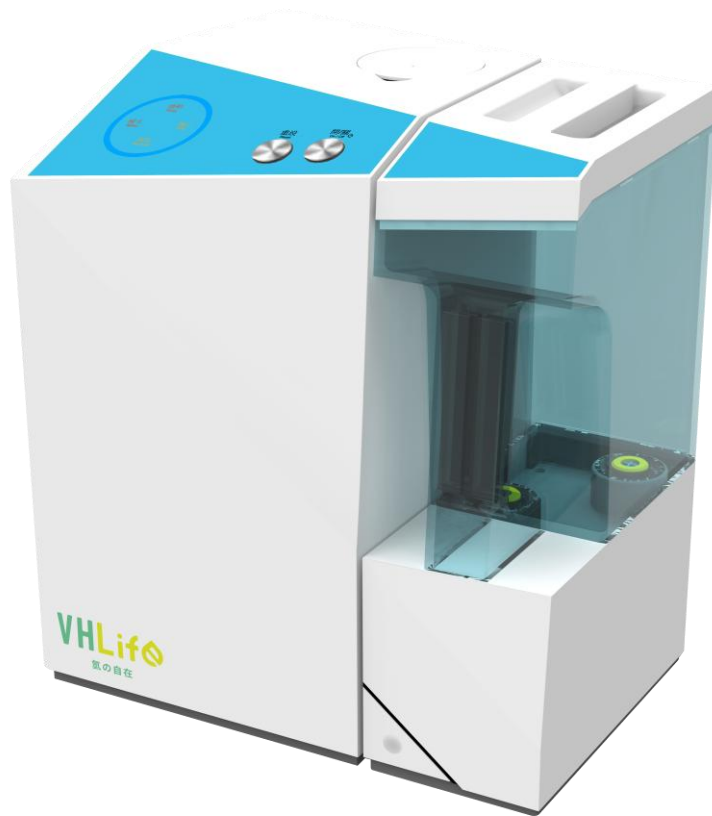

Model : VH600 / VH1500

Index

Disclaimer	3
Attention	3
Contents	5
Product Specifications	6
Parts Description	7
H-cube Operation Procedure	9
W-cube Operation Procedure (Optional)	11
Filter Replacement Procedure	14
Reset Default Operating Time	15
Water Draining Procedure	15
Use of Oxygen Accessories (Optional)	16
Troubleshooting	17
APP Manual	19
Warranty Terms and Conditions	23
Customer Support	24
Warrant Card	25

※ 使用前請詳細閱讀說明書和保固證明，閱讀後請妥善保存，以備不時之需

※ 保固證明上的購買日期請務必填寫，並請經銷商加蓋店章後妥善保管

※ 因安裝錯誤或不正確使用，而造成產品故障或發生事故時，本公司恕不負責

Disclaimer

- ※ Vigorous Health Company Limited reserves the rights to change product specifications and modifications of this document without further notification.
- ※ No one may copy, reproduce or transmit this document in any way for any purpose without obtaining consent from our company.

Attention

1. Please read this manual carefully and follow operating instructions properly before use. This warranty does not cover normal wear of parts, damages or accidents/injuries resulting from negligent use or misuse of the product.
2. **Caution: Hydrogen may be inflammable and explosible under certain concentration. To ensure safety, stay away from fire, and use it only in good ventilation condition.**
3. DO NOT disassemble the rear lid or any part of the enclosure, or else warranty is invalid. This product contains high voltage components and may cause severe injuries if accidentally touched.
4. Keep away from water when using this product. Warning: Do not expose this product to the rain or humid environment to reduce risks of fire or electric shock.
5. DO NOT expose this product to the sun or other heating sources. For instance, the heat generator, warmer, stove or any other heating appliance.
6. Use this product in locations with good ventilation. DO NOT place any object over the heat vents to avoid any possible damage due to improper heat dissipation.
7. DO NOT put any heavy object onto this product or the connected power cord.
8. In case of fire, odor or abnormal noise, shut down the machine immediately and contact the distributor, representative or our company. It is unsafe to continue using it.
9. DO NOT tilt this product during transportation to avoid internal water leak, which may cause electric short and damage. Drain out the water before transporting to a longer distance. Refill the water when it is in place.
10. Only install water filters provided by the original manufacturer.
11. Only purified water that meets the standard requirements shall be added into the water tank. Water standard requirements are: Purified water/ Reverse Osmosis (RO) processed water/ Distilled water/ Ion exchanged filtered water/ Water with conductivity <50 $\mu\text{S}/\text{cm}$ or TDS < 25mg/L. Adding water that does not meet the requirement may result in product impairment, shorter life expectancy and void your warranty.

12. For safety purpose, DO NOT remove the ground wire of the power plug.
13. Avoid stepping on the power cord, the plug, the power outlet and the connection port. Place this product as close to the power cord as possible.
14. Make sure the power outlet has stable power voltage. The plug must be firmly connected to the outlet to avoid possible breakdown or accidents.
15. Never allow children to operate the machine independently to avoid any possible accident. Make sure to unplug machine when leaving.
16. Only factory certified parts and accessories are allowed to avoid damages to the product.
17. Maintenance and repairment have to be done only by the original manufacturer or designated distributors.
18. Contact qualified agents or distributors for inspection or repairment in case of damages; such as impaired power cord/plug, liquid splash or objects dropped into the product, the equipment fallen on the ground or malfunction caused by damped environment.
19. Clean the surface of kettle, lid, base and connecting port periodically, where germs and dirt are easily accumulated.
20. If the H-Cube will not be used for longer than a week, please drain and dry the water tank, also take the filter out and dry it in the shade to avoid bacterial growth. Please refer to P. 39 for Water Draining Procedure.
21. If the W-Cube will not be used for longer than a week, please drain and dry the kettle. Clean the base thoroughly prior to the next use, i.e., run 1 to 2 cycles using 300ml or more drinking water, and pour the water out to maintain the cleanness of the pump.
22. The water tank of H-Cube can hold approximately 300-350ml of water. There are two water level sensors that detect low and full water level. When the water is lower than the low water level sensor, it will trigger a warning sound and the "water" indicator will light. It takes about 200-250ml of water to fill the water level from low to full, once the water level is above full water level, the system will make a warning sound and the "water" indicator will be off. You may also manually press the "reset" button if the water level does not go above the full water level sensor. As long as the water level is higher than the low water level sensor, the system will make a warning sound and turn off the "water" indicator. It can then be used normally.

Contents

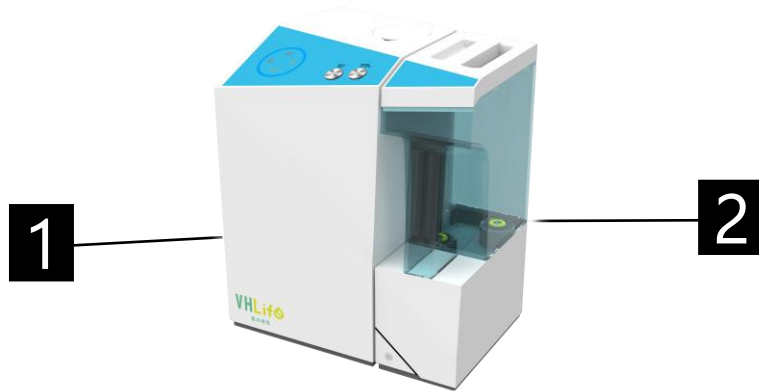

3



4



5



6



7



8



9



10

1. H-Cube
2. W-Cube(Optional)
3. Power cord
4. Water tank filter
5. External water collector
6. Two-way hose
7. Nasal cannula
8. Drain tube
9. Oxygen collecting cap (Optional)
10. Y shape tube (Optional)

Product Specifications

H-Cube (Hydrogen generator) W-Cube (Hydrogen Rich Water Kettle)	
H ₂ Flow Rate	600 cc/min
H ₂ Purity	>99.999%
Power Consumption	190W / 200W
Voltage	100-240V
Dimension	18*18*32 / 18*31*32 cm
H-Cube Water quality requirements	Conductivity < 50 μ S/cm TDS < 25 mg/L
W-Cube Water quality requirements	Drinking water
Net Weight	4 Kg / 5 Kg
H ₂ Concentration in HRW	1200 \pm 100 ppb
Place of Origin	Taiwan

Parts Description

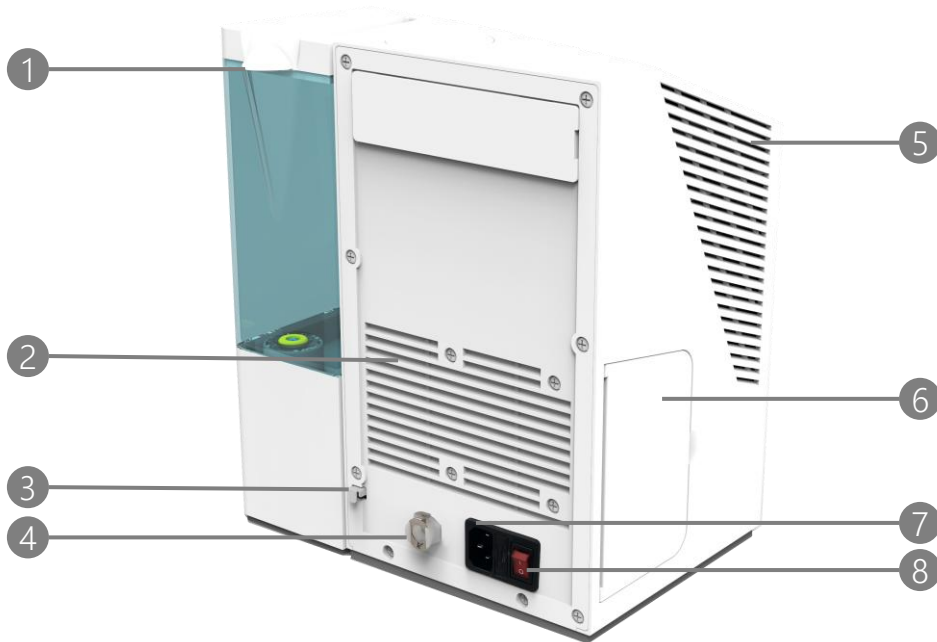

- | | |
|------------------------|-----------------------|
| 1. Kettle water outlet | 5. Heat vent |
| 2. Heat vent | 6. The protection lid |
| 3. Latch | 7. Power socket |
| 4. Water drain port | 8. Main power switch |

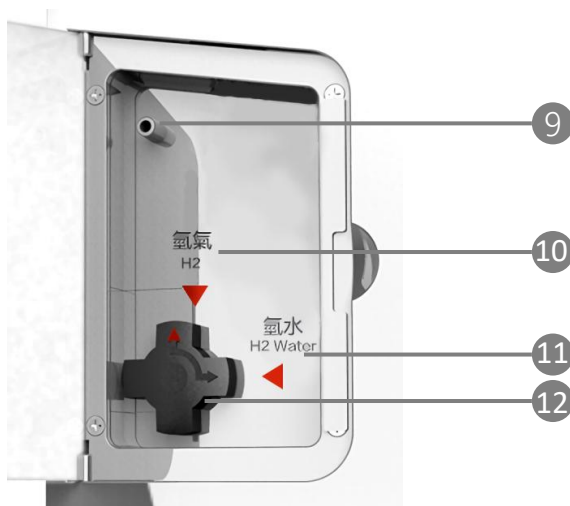

- | |
|------------------------------|
| 9. Hydrogen outlet |
| 10. Hydrogen indicator |
| 11. Hydrogen water indicator |
| 12. Switch knob |

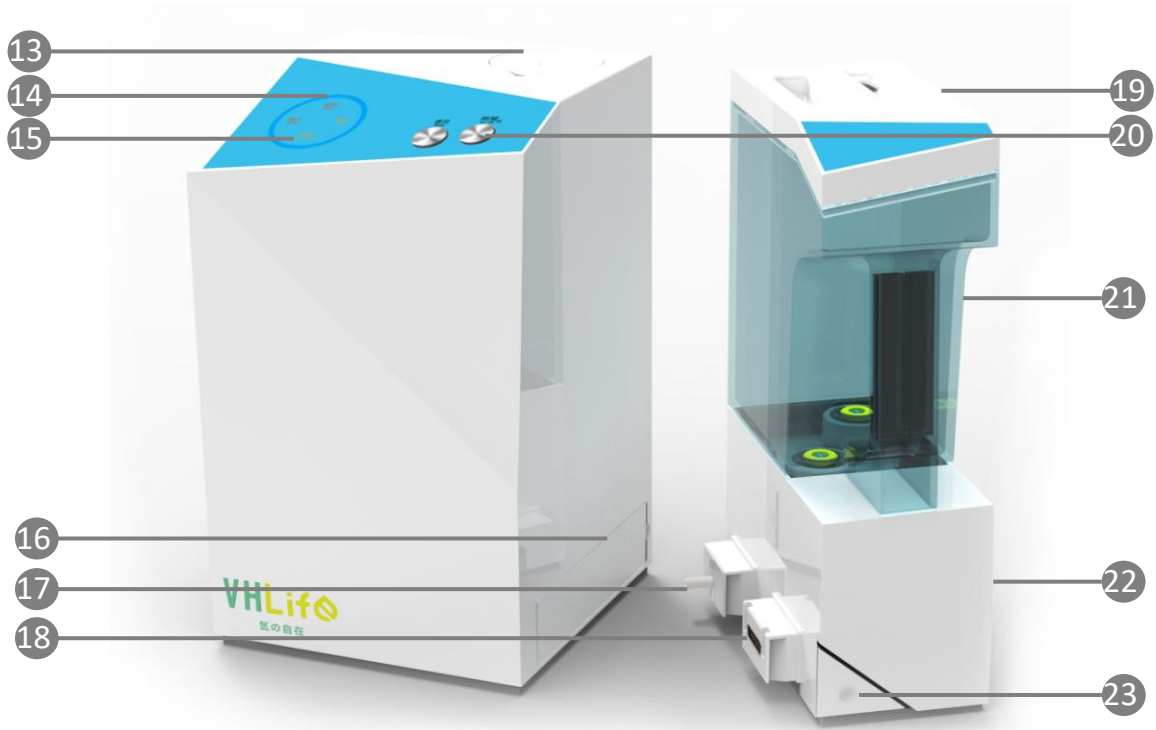

- | | |
|----------------------------------|-----------------------------|
| 13. Water tank lid | 19. Kettle cover |
| 14. Standby/operating ring light | 20. Reset and on/off button |
| 15. Event LED indicators | 21. Water kettle |
| 16. Connector cover | 22. Water kettle base |
| 17. Hydrogen connector | 23. W-cube on/off button |
| 18. Electrical connector | |

H-Cube Operation Procedure

- 1** Plug in the power cord into the outlet at the back of H-Cube



- 2** Turn on the main power switch at the rear of H-Cube. A 5-second self diagnosis will begin with all indicators flashing.

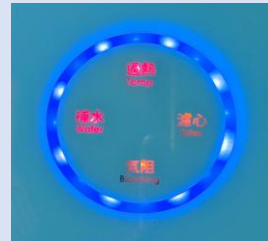

- 3** For initial use, to clear the "Water" indicator, you need to open up the lid and install the filter into the water tank. Afterwards, pour distilled or filtered water into the tank gradually until the "Water" indicator is off. The status light will then turn green with two beeping sounds, indicating the system is now in standby mode.

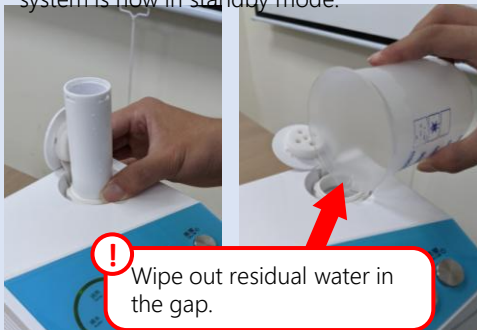

! Wipe out residual water in the gap.



- 4** For subsequent use, the system will turn into green light directly. Add water only when the "Water" indicator is lit.

- 5** To avoid excessive water vapor, water should not exceed the hole of max level indicator. Refer to P. 39 to drain the exceeding water.

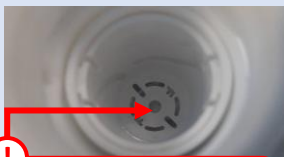

! Max level indicator.

- 6** Open up the protection lid on the side of H-Cube. Connect the external water collector with the two-way hose.

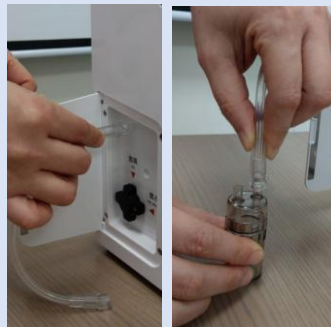

! Do Not lay flat the external water collector to prevent water flowing out through the tube.

- 7** Connect the nasal cannula with the other side of the external water collector .



- 8** Make sure the switch knob inside the protection lid has been turned to "H2".



- 9** For first time use or each time after filter changed, press and hold the "Reset" button for 5 seconds to clear the "Filter" indicator. The system will reset the counter for another 6 months.



- 10** By pressing the "On/Off" button, the status light will turn into flashing blue, indicating the system is generating hydrogen.



- 11** H-Cube will stop automatically when reaching 2-hour default operating time. Press the "On/Off" button anytime during the operating mode will stop hydrogen generation and enter standby mode. If you want to reset the default operating time, please refer to P. 39.

- 12** Start enjoying the benefits from breathing hydrogen.

- H2 Upgrades Your Life -

W-Cube Operation Procedure (Optional)

- 1** Remove the connector cover on the side of H-Cube. Place it on the upper slot at the rear of H-Cube.



- 2** Turn off the main power first then connect the base of W-Cube and H-Cube by pressing it together. When both units are firmly latched, you may hear a clicking sound.



- 3** Fill the drinking water to the kettle, up to 1200ml (marked maximum capacity).



- 4** To put the lid on the kettle properly, simply hold the lid and insert the slanted side first. Then, pressing down the other side.



- 5** Place the kettle onto the base in an upright position. Pressing down the W-Cube and make sure it is firmly attached to the base so there is no gap between kettle and the base.

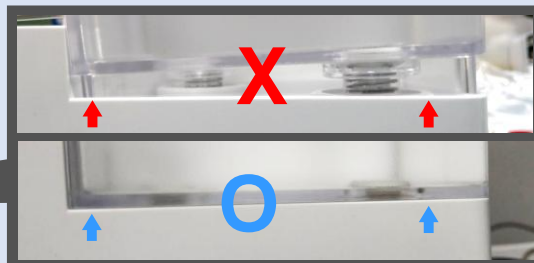

- 6** Plug in the power cord at the rear of the H-Cube.

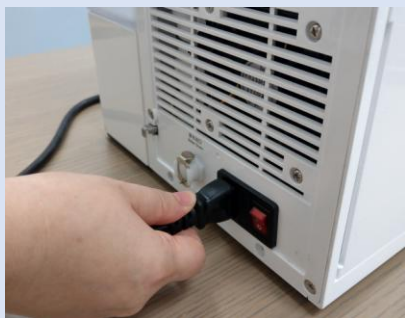

- 7** Open up the protection lid on another side of H-Cube. Make sure the switch knob has turned to "H2 Water". Then close the lid.



- 8** Turn on the main power switch at the rear of H-Cube. A 5-second self diagnosis will begin with all indicators flashing.



- 9** After entering the standby mode, the status light of H-Cube and W-Cube will turn green and blue respectively.

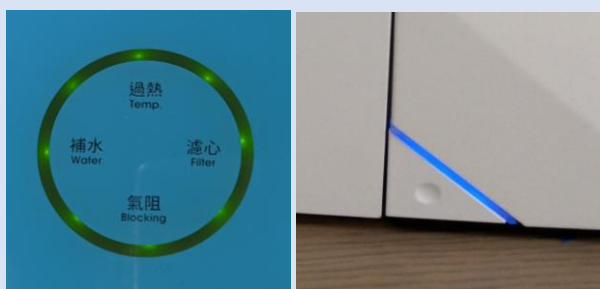

- 10** Press the triangle button on the base of W-Cube to make hydrogen rich water. Both status lights on H-Cube and W-Cube will be flashing, indicating the system is mixing hydrogen into water.



- 11** The default operating time for hydrogen rich water mixing is 2 minutes. It will stop when the water is ready. Press the triangle button anytime if you need to stop during the process.

13 To take out the kettle from the base, simply press the H-cube or the kettle base with one hand and lift the kettle up with the other hand.



! It is normal to have a small amount of residual water in the connection port and cause minor dripping.

14 To separate the H-Cube from W-Cube, first turn off the main power switch while the system is in standby mode.

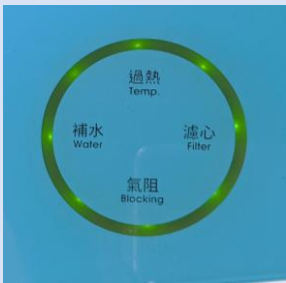

15 Press the latch on the back of H-Cube to detach them.

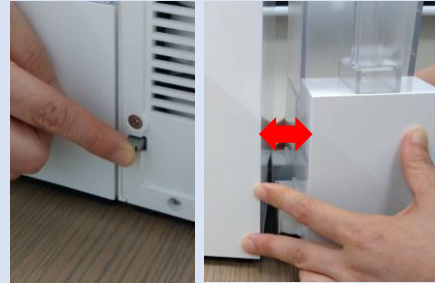

16 Start enjoying the benefits from drinking hydrogen-rich water.

- H2 Upgrades Your Life -

Filter Replacement Procedures

1 Filter replacement frequency depends on water quality. For optimum results, replace the filter at least every 6 months. You may need to replace filters more frequently if quality of water is less satisfied.

2 When it's time to replace the filter, the "Filter" indicator will light up as a reminder.

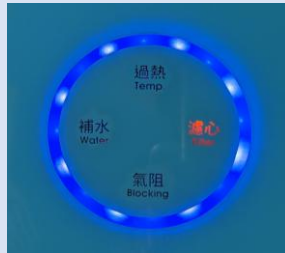

3 Shut off the main power at the rear of H-Cube before filter replacement.



4 Open up the lid of water tank on H-Cube.



5 Pull out the filter from the water tank.



6 Insert the new filter.



7 Close the Lid.

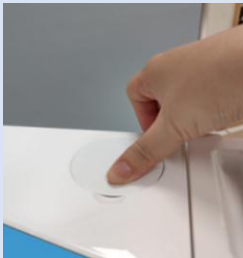

8 Turn on the main power at the rear of H-Cube. Then press and hold the "reset" button for 5 seconds to clear the filter change reminder. The timer will reset for another 6-month for filter replacement.



Reset Default Operating Time

- 1 The system has a 2-hour default operating time. To reset operating duration, press and hold the "On/Off" button, and click the reset button to the desired duration.



- 2 You may adjust different operation durations based on brightness of the status light. 4 different options are available, ranging from 1-hour (dimmiest), 2-hour, 4-hour to 8-hour (brightest).

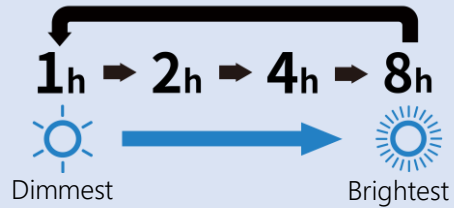

Water Draining Procedure

- 1 Place the back of H-Cube to the edge of a table.



- 2 Prepare a water cup and the drain tube.



- 3 Plug in the connector of the drain tube into the draining outlet until a clicking sound has been heard.



- 4 When the draining is done, or the procedure needs to be stopped. Simply press the metal button of the draining outlet. Then, the draining tube will pop out.



Use of Oxygen Accessories (Optional)

- 1** Open up the water tank lid, mount the oxygen collecting cap on the tank and make sure to press it down for airtight.



- 2** Connect the blue hose of Y shape tube to the outlet of oxygen cap, then connect the other connector to the hydrogen outlet, the last connector is to be connected to the external water collector for H₂/O₂ inhalation.

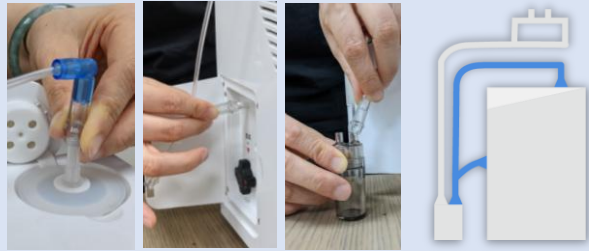

Maintenance and Cleaning

- 1** Cloth or cotton buds can be used to clean the lid and the outer rim of water tank.



- 2** It is recommended to clean the vents on the side and the back of H-Cube with a brush or a clean cloth regularly to avoid dust accumulation.



- 3** It is recommended to use a clean cloth or cotton bud to clean the W-Cube base and kettle, especially the gap around the connectors.



- 4** For easy attach and detach the kettle, drip few drops of cooking oil on a cotton bud and apply it on the inside of the connectors at the bottom of the kettle.

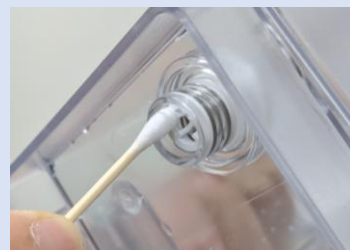

Troubleshooting

No power

1. Check if the power cord has been plugged on properly.
2. Examine if the main power at the rare of H-Cube has been turned on.

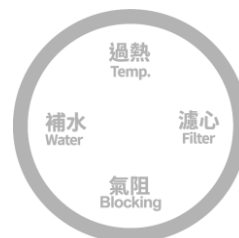

"Water" indicator lit

1. Check if the water tank has enough clean water.
2. Add distilled/filtered water gradually until the "Water" indicator is off.



"Filter" indicator lit

1. The system has a built-in 6 months filter change reminder. When the indicator lights up, refer to previous section on "Filter Replacement Procedures" to replace the filter.
2. After filter replacement, press and hold the "Reset" button for 5 seconds and the system will recount for another 6 months.



"Temp" indicator lit

1. When the inside temperature exceeds certain level, the overheat signal (Temp) will light up. H-Cube will stop but the cooling fan remains running until the temperature has decreased to the ideal level and the indicator is off.
2. When the indicator is off, press the "Reset" button and the system will return to the standby mode.

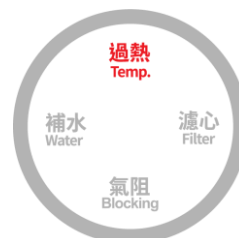

"Blocking" indicator lit

1. When the hydrogen (H2) outlet is blocked, this indicator will light up and shut down the system automatically.
2. Check if the nasal cannula is bent or blocked.
3. When problem solved, press the "Reset" button and the system will go into standby mode.



“Tilt” indicator lit

1. Make sure if the unit is placed upright on a flat surface.
2. Press the “Reset” button and the system will go into standby mode.

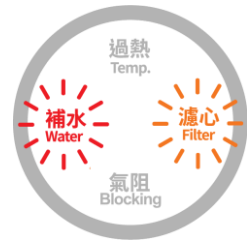

“Power abnormal” indicator lit

1. Check the vents and make sure they are not clogged.
2. Turn off the power and wait for 30 minutes to restart the system.

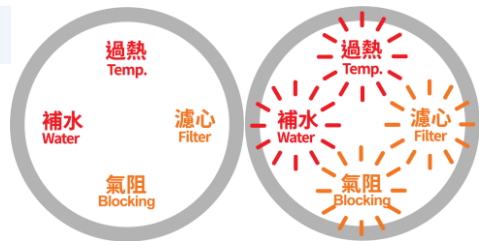

“Fan abnormal” indicator lit

1. Check the vents and make sure they are not clogged.
2. When the problem is solved, press the “Reset” button before restarting the system.

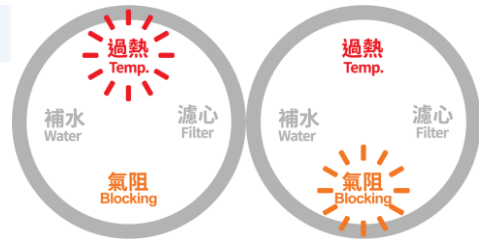

W-Cube unable to produce fine bubbles

1. Make sure the switch knob inside the protection lid of H-Cube has been turned to “H2 Water”.
2. Make sure to press on the “triangle” button on W-Cube, NOT the “On/Off” button on the H-Cube.
3. Make sure that the H-Cube and W-Cube are properly latched.

※ If none of above fix problems, please contact your local agent or distributors for technical service.

APP Manual

Connecting the device



Search for "H2 Cube" on the App Store or Google Play, or scan the QR Code to download the App. After installed, please follow the App requirements to turn on the Bluetooth and camera permissions to connect to the device.

Requires iOS 12.0 / Android 9.0 or later.

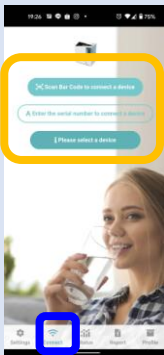

There are three ways to connect to your H2 Cube:

1. Scan bar code
2. Enter the serial number
3. Select the device from a list

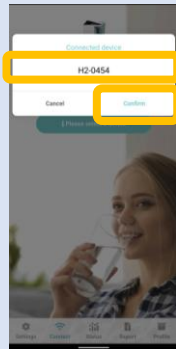

1. Scan bar code

Click the "Scan Bar code to connect a device" and use the camera to scan the barcode on the back of the machine, the App will automatically read the machine number.

The serial number will be displayed, and then press the confirm button to connect to the device .

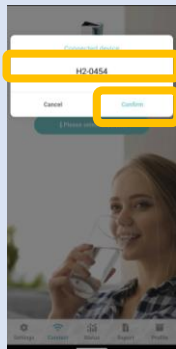
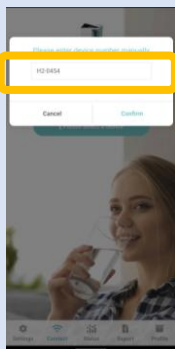

2. Enter the serial number

Click "Enter the serial number to connect a device" and enter the serial number. The serial number can be located on the packing box and is identical to the bar code on the back of the device, usually in H2-XXXX format. XXXX is a four-digit number.

After the App is connected to the device, the serial number will be displayed, and then click the confirm button to connect to the device.

3. Select the device from a list
 When click "Please select a device", a historical list at the bottom will appear. These are devices you have connected before. Select the device you wish to connect to, and then press the confirm button.
 The selected serial number will be displayed, and then click the confirm button to connect to the device.

After the device is connected, the main page as the left will appear, and the serial number will be displayed.

There are 5 main tabs in the App, located at the bottom of the screen. The detail features of these tabs will be introduced as follows.

Menu bar: Settings

This allows you to

1. Set runtime duration
2. Remote start/stop device
3. Display remaining time

1. Set runtime duration
 You can select a runtime duration from the drop-down menu. Available durations are 30 minutes to 8 hours for a single run with an interval of 30 minutes. After selecting, press the confirm key to save the setting as default.

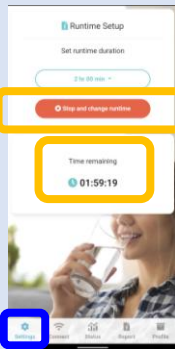

2. Remote start/stop device
Click "Start" to start the device with the default runtime. If you want to stop the device or change the runtime again, you need to click the "stop and change runtime"

3. Display remaining time
The countdown of the remaining time will be displayed at the bottom.

Menu bar: Connection

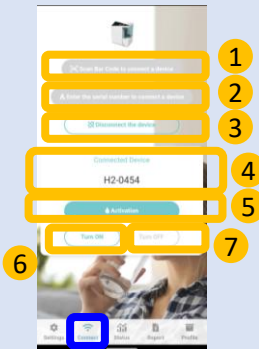

This allows you to

1. Scan bar code to connect a device
2. Enter serial number to connect a device
3. Disconnect the device
4. Display the connected device
5. Start the activation process
6. Turn on the device
7. Turn off the device

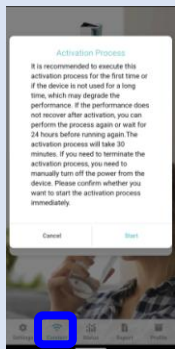

"Activation" is mainly used when the device has not been used for a long time (more than three months). The hydrogen generating cell will become too dry to work. This process pumps water into hydrogen generating cell and keeps it moist. When click the "Activation", a dialog box will appear. Click "start" to initiate the process.

Menu bar: Status

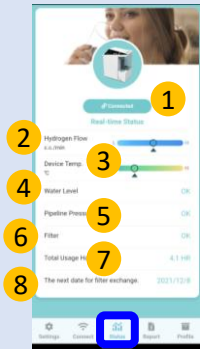

Status displays the following info

1. Connection
2. Hydrogen flow rate
3. Device temperature
4. Water level
5. Pipeline pressure
6. Filter
7. Total usage hour
8. The next date for filter replacement (NG: require your attention to address the issue)

Menu bar: Report



Report shows all exception information and the suggested troubleshooting methods will be displayed as well. When the issue is resolved, you need to press the "reset" button on the device panel. If the device is working normally, it will display "No Error" as shown in the figure below.

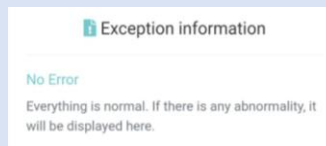

Menu bar: Profile



Profile Features:

1. Language setting: supports Traditional Chinese, Simplified Chinese and English.
2. App version information.
3. Engineering mode: It shows the exactly hydrogen flow rate and device temperature.
4. Manual input mode: It can change parameters of the device. Must be used under the guidance of the original manufacturer.

Warranty Terms and Conditions

Warranty Period

1. Vigorous Health Company Limited warrants this product to be free from defects in manufacturing and provides free after services for a period of 15 months from the date of purchase under normal use. This warranty extends only to the original purchaser.
2. No warranty service will be provided to consumable materials, such as filters.
3. The warranty does not extend to free gifts from purchase. All parts except for the main unit, if defected, please present warranty cards or purchase certificate to eligible distributors for exchange within 7 days. No exchange will be granted afterwards.
4. The warranty card must be stored properly for the purpose of service. Within warranty period, the ownership for replaced parts will be transferred to our company.

Warranty Subjects

This warranty only applies to original purchaser.

Warranty conditions

1. This warranty only applies to damages under normal use and/or defects in manufacturing and material within warranty period.
2. This warranty does not cover damages due to below reasons. Additional service fee may apply, including:
 - a. Broken, erased, or removed product serial numbers.
 - b. Damages resulted from accidents, improper use, negligence, fire, flood, lightening and/or other natural disasters.
 - c. Damages caused by reasons other than the product itself, such as unstable electricity, and electricity failure.
 - d. Damages caused by using uncertified parts.
 - e. Damages caused by incorrect installation, assembly without following the manual and/or operations under improper conditions.
 - f. All repairs/disassembly for which warranty claims are made must be pre-authorized by our company. No warranty will be provided if otherwise.
 - g. Normal wear and tear.

Warranty Service

1. Replacement will be provided with identical new/used parts within warranty periods.
2. Repaired items must be directed or submitted by authorized distributors to manufacturer. No on-site service is available under warranty terms and conditions.
3. Customers may request repairment service by authorized distributors along with valid warranty card within warranty period.
4. Products not eligible for free warranty service may require additional service fees. These fees will be notified and authorized by end user prior to any repairment.
5. Electronic devices of other manufactures claimed to be damaged by our products must be examined before any compensation.
6. Warranty services do not apply to damages of our products confirmed to be caused by electronic devices made by other manufactures.

Customer Support

For further technical support or product services, please refer to the following information or contact the local agent or distributor.

Notice: Please present your product serial number if required.

Vendor	Vigorous Health Company Limited
Address	2F., No. 7-3, Sec. 3, Ren Ai Rd., Da An Dist., Taipei 106, Taiwan
Phone	+886-2-27110881
E-mail	service@vhlife.com

For more information, please visit: www.vhlife.com

保固證明

VHLife

產品保固證明 Warranty Card

經銷/代理商：

購買日期：

產品序號：

註冊密碼：

姓名：

電話：

電子信箱：

住址：

VH600 氫氣機

VH1500 氫水機

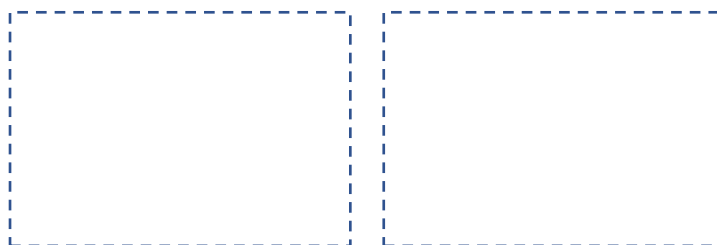

Warranty Stamp 保固章

※為確保您的權益，請將以上資料填寫完整，將享有自購買日期起原廠提供的
2年保固服務，未蓋保固章或未填寫購買日期者，則以出廠日期計算。

VHLife